

# GE Healthcare - ModuCon™ for B23 Room 16

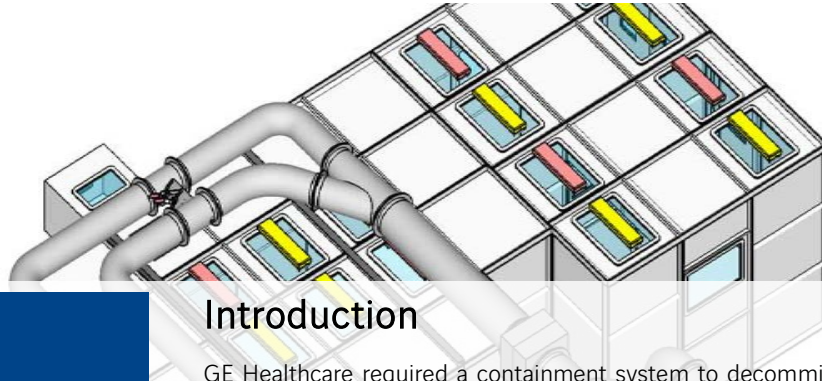

- **CLIENT**  
GE Healthcare
- **LOCATION**  
Amersham

## Introduction

GE Healthcare required a containment system to decommission and process existing PCM waste and various radiological contaminated equipment. The ModuCon™ system has been used on site previously and was selected for this project by the client. The Modular Containment System (MCS) is comprised of three areas, the main work area, an entry module and a waste transfer module. The MCS is ventilated to nuclear standard and utilises an existing Mobile Filtration Unit (MFU). The MCS will be installed by Nuvia ModuCon™ SQEP operatives and the ventilation system will be installed by Applied Engineering under Nuvia's control.

### Scope of Work:

Design, manufacture, Supply & Installation of ModuCon™ unit and connecting ventilation extract system.

### Project Challenges:

The MCS and ventilation system is to be installed within a laboratory area. The area is restricted in height and must clear obstacles within the lab area. The ventilation system has to be routed above the MCS in the roof ceiling void and routed through an adjacent wall and connected to the clients existing MFU.

### Technical Solutions:

The ModuCon™ system has been chosen due to its flexibility and can be tailored to suit the client's requirements.

GE Healthcare are decommissioning various facilities on site which require containment, ModuCon™ has already been selected as a viable solution and discussions are on-going with them.

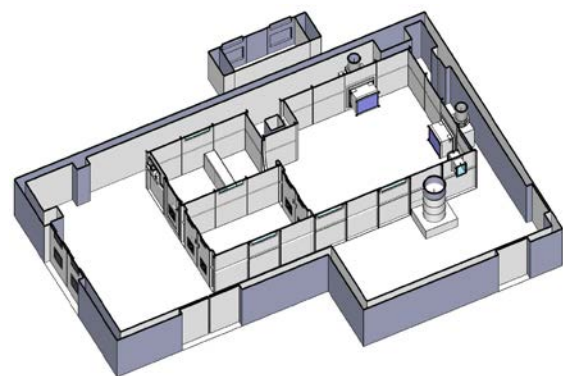
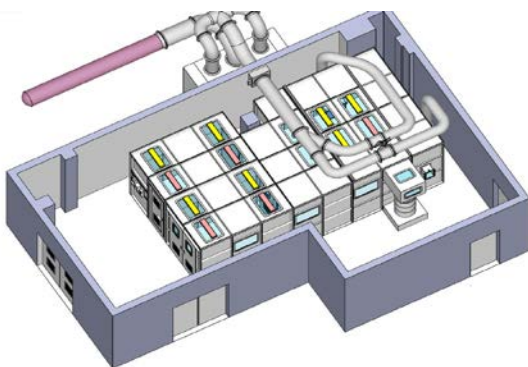

Timescale is a key factor for the client as they have scheduled decommissioning operations.

Profile Ref: 3489-431